

# OUTDOOR RECREATION EQUIPMENT CHECKOUT FEES ACTIVITIES & FACILITIES



📍 4290 W. Thunderbolt Ave., Bldg.  
450 Grissom ARB, IN 46971

📞 (765) 688-2000

✉️ grissomodr@gmail.com

*Find us online!*

📘 Find us on Facebook!  
GRISSOM ARB SERVICES

Current as of February 2021  
Prices are subject to change without notice.

Hours of Operation:  
Mon- Fri 0800-1530

**GRISSOMFSS.COM**

# CAMPING EQUIPMENT

	Daily	Weekend	Holiday	Weekly
Tent (4 Person)	\$7.00	\$14.00	\$17.50	\$35.00
Tent (6 Person)	\$10.00	\$20.00	\$25.00	\$50.00
Sleeping Bag	\$3.00	\$6.00	\$7.50	\$15.00
Cot	\$1.00	\$2.00	\$2.50	\$5.00
Kamp Rite Tent Cot (1 Person)	\$7.00	\$14.00	\$17.50	\$35.00
Camping Chair	\$2.00	\$4.00	\$5.00	\$10.00

# BIKES AND GAMES

	Daily	Weekend	Holiday	Weekly
Electra 3 Speed Bike	\$8.00	\$16.00	\$20.00	\$40.00
POV Bumper Bike Rack	\$4.00	\$8.00	\$10.00	\$20.00
RV Bike Rack	\$4.00	\$8.00	\$10.00	\$20.00
Adult Size Big Wheels (set of 4)	\$25.00	\$50.00	\$62.50	\$125.00
Whacky Trikes	\$25.00	\$50.00	\$62.50	\$125.00
Corn Hole	\$2.00	\$4.00	\$5.00	\$10.00
Dunk Tank	\$40.00	\$80.00	\$100.00	\$200.00
Horse Shoes	\$2.00	\$4.00	\$5.00	\$10.00
Volleyball Set	\$2.00	\$4.00	\$5.00	\$10.00
Football Toss	\$2.00	\$4.00	\$5.00	\$10.00
Frisbee Golf (9 holes)	\$20.00	\$40.00	\$50.00	\$100.00
Ball Hitch	\$5.00	\$10.00	\$7.50	\$25.00
Electric Adapter	\$2.00	\$4.00	\$5.00	\$10.00
Propane/Per Pound	\$2.00	\$4.00	\$5.00	\$10.00
Snow Shoes	\$2.00	\$4.00	\$5.00	\$10.00
Snow Blower	\$25.00	\$50.00	\$62.50	\$125.00
Santa Suit	\$35.00	\$70.00	\$87.50	\$175.00
Easter Bunny Suit	\$35.00	\$70.00	\$87.50	\$175.00

# INFLATABLE & GROUP EVENT ITEMS

	Daily	Weekend	Holiday	Weekly
Bounce Inflatable Camouflage Bouncer Sports Bouncer Obstacle Course Inflatable Human Football	\$100.00	\$175.00	\$225.00	\$525.00
Water Slide White/ Blue Shark Tank Slip & Slide	\$110.00	\$175.00	\$230.00	\$595.00
Inflatable Bounce Horse	\$48.00	\$96.00	\$120.00	\$240.00
Coolers	\$2.00	\$4.00	\$5.00	\$10.00
Tables (6' & 8')	\$2.00	\$4.00	\$5.00	\$10.00
Round Tables (5' & 6')	\$2.00	\$4.00	\$5.00	\$10.00
Folding Chairs	\$1.00	\$2.00	\$2.50	\$5.00
White Chairs	\$2.00	\$4.00	\$5.00	\$10.00
EZ-Up 10'x10'	\$20.00	\$40.00	\$50.00	\$100.00
EZ-UP 10'x15'	\$25.00	\$50.00	\$62.50	\$125.00
EZ-UP 10'x20'	\$30.00	\$60.00	\$75.00	\$150.00
Towable Charcoal Grill	\$15.00	\$30.00	\$37.50	\$75.00
Large Gas Grill	\$20.00	\$40.00	\$50.00	\$100.00
Towable Gas Grill	\$35.00	\$70.00	\$87.50	\$175.00
Towable Steamer Grill	\$35.00	\$70.00	\$87.50	\$175.00
Party Tent 10'x20'	\$55.00	\$110.00	\$137.50	\$275.00
Party Tent 20'x30'	\$65.00	\$130.00	\$162.50	\$325.00
Party Tent 20'x30'	\$65.00	\$130.00	\$162.50	\$325.00
Snow Cone Machine	\$30.00	\$60.00	\$75.00	\$175.00
Popcorn Machine	\$30.00	\$60.00	\$75.00	\$175.00
Cotton Candy Machine	\$30.00	\$60.00	\$75.00	\$175.00

## LAWN & HOME

	Daily	Weekend	Holiday	Weekly
Chipper	\$20.00	\$40.00	\$50.00	\$100.00
Large Chipper	\$35.00	\$70.00	\$87.50	\$175.00
Log Splitter	\$35.00	\$70.00	\$87.50	\$175.00
Lawn Roller / Aerator	\$10.00	\$20.00	\$25.00	\$50.00
Power Auger (6' & 8')	\$20.00	\$40.00	\$50.00	\$100.00
Roto Tiller (Sm Rear Tine)	\$20.00	\$40.00	\$50.00	\$100.00
Roto Tiller (Lg Rear Tine)	\$25.00	\$50.00	\$62.50	\$150.00
Roto Tiller (Lg Rear Tine)	\$25.00	\$50.00	\$62.50	\$150.00
Cement Mixer	\$30.00	\$60.00	\$75.00	\$150.00
Power Washer Electric	\$10.00	\$20.00	\$25.00	\$50.00
Power Washer Gas	\$20.00	\$40.00	\$50.00	\$100.00
Rug Doctor (Sm)	\$20.00	\$40.00	\$50.00	\$100.00
Rug Doctor (Lg)	\$25.00	\$50.00	\$62.50	\$150.00
Generator 6 kw	\$25.00	\$50.00	\$62.50	\$150.00
Genrator 6 kw	\$30.00	\$60.00	\$75.00	\$150.00

## WATER CRAFT

	Daily	Weekend	Holiday	Weekly
Canoe/Kayak	\$13.00	\$27.00	\$33.50	\$64.00
6-pack Canoe	\$45.00	\$90.00	\$112.25	\$225.00
4-pack Kayak	\$36.00	\$72.00	\$90.00	\$180.00
Paddle Boards	\$15.00	\$30.00	\$37.50	\$75.00
Life Jackets	\$2.00	\$4.00	\$5.00	\$10.00
Paddles/Oars	\$2.00	\$4.00	\$5.00	\$10.00

# BOATS

## For the Rental of Boats:

A boaters Safety Course certificate certified by the US Coast Guard is required. These can be acquired with a FREE Online test through

<http://www.boatus.org/indiana>

### Reservation Information:

- You can reserve up until 3 months in advance.
- Boats require 24 hour advanced notice of reservation.
- Boat pick up is by 3pm and return is by 12pm Mon through Fri
- Boat check out/in is extensive and can take up to 30 minutes to complete.

### Boat "Jon"

Flat Bottomed Boat

**Towing information:** 800 lbs, 14 ft, require a class 2 hitch (no bumper hitches) 2 inch ball and 4 flat electrical plug (no adapters)

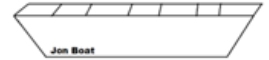

**Features:** can seat 3-4, comes on a trailer with a 8 HP motor seat cushions, life jackets, oars, bailing bucket, anchor

### Prices

- Security Deposit: \$15.00 due at reservation, non-refundable if canceled within 7 days of reservation
- Daily: \$15.00
- Weekend: \$30.00 (Friday pick-up to Monday drop-off)
- Holiday Weekend: \$37.50 (if we are closed for a holiday: Fri to Tues or Thurs to Mon)
- Weekly: \$67.50 (7 days, Friday to Friday, Thursday to Thursday, Etc.)

### Bass Boat "Tracker"

V-Hull Boat

**Towing information:** 800 lbs, 14 ft, require a class 2 hitch (no bumper hitches) 2 inch ball and 4 flat electrical plug (no adapters)

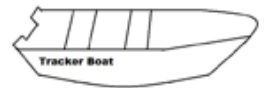

**Features:** can seat 3-4, comes on a trailer with a 25 HP motor seat cushions, life jackets, oars, bailing bucket, anchor

### Prices

- Security Deposit: \$65.00 (due at reservation, non-refundable if canceled within 7 days of reservation)
- Daily: \$65.00
- Weekend: \$130.00 (Friday pick-up to Monday drop-off)
- Holiday Weekend: \$162.50 (if we are closed for a holiday: Fri to Tues or Thurs to Mon)
- Weekly: \$325.00 (7 days, Friday to Friday, Thursday to Thursday, Etc.)

# PONTOON BOAT

## Lowe UF162

"Fish and Cruise" Pontoon

**Features:** 16 foot deck; Holds up to seven (7) passengers OR 1700 lbs. Canopy sun top for shade. 50 HP motor. Under seat storage.

**Towing information:** Requires a minimum class 2 hitch (no bumper hitches), weighs 2470 pounds (unloaded), 18 ft. (trailer length), ball size 2 inch, 5 flat electrical plug (4 flat adapter provided). 4x4 or all wheel drive vehicles are suggested for towing, but not required.

**Additional Information:** Fuel tank is half full upon rental. Customer is responsible for returning the fuel tank half full, or a \$50.00 fee will be incurred.

### Pricing:

- Security Deposit: \$145.00 (due at reservation, non-refundable if canceled within 7 days of reservation)
- Daily: \$145.00
- Weekend: \$290.00 (Friday pick-up to Monday drop-off)
- Holiday Weekend: \$362.50 (if we are closed for a holiday: Fri-Tues or Thurs-Mon)
- Weekly: \$725.00 (7 days, Friday to Friday, Thursday to Thursday, Etc.)

# SPEED BOAT

## Hurricane SS188-OB

"Ski Boat"

**Features:** 16 foot deck; Holds up to ten (10) passengers OR 3625 lbs. Canopy sun top for shade. 350 HP motor. Under seat storage.

**Towing information:** Requires a minimum class 2 hitch (no bumper hitches), weighs 2425 pounds (unloaded), 18 ft. (trailer length), ball size 2 inch, 5 flat electrical plug (4 flat adapter provided). 4x4 or all wheel drive vehicles are suggested for towing, but not required.

**Additional Information:** Fuel tank is half full upon rental. Customer is responsible for returning the fuel tank half full, or a \$50.00 fee will be incurred.

### Pricing:

- Security Deposit: \$175.00 (due at reservation, non-refundable if canceled within 7 days of reservation)
- Daily: \$175.00
- Weekend: \$350.00 (Friday pick-up to Monday drop-off)
- Holiday Weekend: \$437.50 (if we are closed for a holiday: Fri-Tues or Thurs-Mon)
- Weekly: \$875.00 (7 days, Friday to Friday, Thursday to Thursday, Etc.)

# TOWABLE CAMPER TRAILERS

## Reservation Information For All Campers

- You can reserve up until 3 months in advance.
- **Campers require at least 48 hours advanced notice of reservation.**
- Camper pick up is by 3pm and return is by 12pm Mon through Fri
- Cleaning fee will be applied if camper is returned dirty or black-water tanks have not been emptied
- **Camper check out/in is extensive and can take up to 1 hours to complete**

### NO SMOKING OR PETS ARE ALLOWED IN THE CAMPER

## Additional Information

- Campers with toilets must have the black-water tanks completely flushed and clean
- Fridges can take up to six hours to cool
- Caution and care must be used with awnings and extended pop-out portions of campers, these items should not be left up/out/extended in high winds

### Dutchmen, 20 ft. Standard

Fully-enclosed, hard shell travel trailer

**Features:** Sleeps four, shower and toilet, gas hot water heater, 2-burner stove, 12 gallon water tank, propane tank, and mini refrigerator.

**Towing information:** Requires a class 2 hitch (no bumper hitches), weighs 3990 pounds (unloaded), 20ft, ball size 2 5/16 inches, 7 round electrical plug (no adapter)

**Additional Information:** Overall length 20', height 10', width 8'

### Prices:

- Security Deposit: \$70.00, due at reservation, non-refundable if canceled within 7 days of reservation
- Daily: \$70.00
- Weekend: \$140.00 (Friday pick-up to Monday drop-off)
- Holiday Weekend: \$175.00 (if we are closed for a holiday: Fri-Tues or Thurs-Mon)
- Weekly: \$350.00 (7 days, Friday to Friday, Thursday to Thursday, Etc.)



**GRISSOMFSS.COM**

# TOWABLE CAMPER TRAILERS

## Amer-lite, 29 ft.

Fully-enclosed, hard shell travel trailer

**Features:** Sleeps six, shower and toilet, gas hot water heater, 3-burner stove, propane tank, electric awning and 6 Cu. ft. 2-door refrigerator/freezer.

**Towing information:** Requires a class 2 hitch (no bumper hitches), weighs 4900 pounds (unloaded), ball size 2 5/16 inches, 7 round electrical plug (no adapters)

**Additional Information:** Overall length 29', height 8', width 7'

### Prices

- Security Deposit: \$90.00, due at reservation, non-refundable if canceled within 7 days of reservation
- Daily: \$90.00
- Weekend: \$180.00 (Friday pick-up to Monday drop-off)
- Holiday Weekend: \$225.00 (if we are closed for a holiday: Fri-Tues or Thurs-Mon)
- Weekly: \$440.00 (7 days, Friday to Friday, Thursday to Thursday, Etc.)



## Summerland, 29 ft.

Fully-enclosed, hard shell travel trailer

**Features:** Sleeps six, shower and toilet, gas hot water heater, 2-burner stove, 12 gallon water tank, sink with pump, propane tank, and mini refrigerator.

**Towing information:** Requires a class 2 hitch (no bumper hitches), weighs 2000 pounds (unloaded), ball size 2 5/16 inches, 7 round electrical plug (no adapters)

**Additional Information:** Overall length 29', height 8', width 7'

### Prices:

- Security Deposit: \$90.00, due at reservation, non-refundable if canceled within 7 days of reservation
- Daily: \$90.00
- Weekend: \$180.00 (Friday pick-up to Monday drop-off)
- Holiday Weekend: \$225.00 (if we are closed for a holiday: Fri-Tues or Thurs-Mon)
- Weekly: \$440.00 (7 days, Friday to Friday, Thursday to Thursday, Etc.)

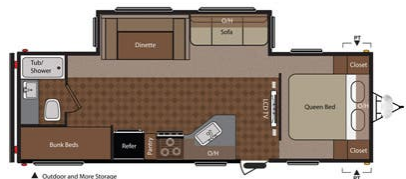



# TOWABLE CAMPER TRAILERS

## Springdale, 29 ft.

Fully-enclosed, hard shell travel trailer

**Features:** Sleeps six, shower and toilet, gas hot water heater, 3-burner stove, 12 gallon water tank, double kitchen sink, propane tank, and refrigerator.

**Towing information:** Requires a class 2 hitch (no bumper hitches), weighs 5950 pounds (unloaded), ball size 2 5/16 inches, 7 round electrical plug (no adapters)

**Additional Information:** Overall length 29', height 11', width 8'

### Prices

- Security Deposit: \$90.00, due at reservation, non-refundable if canceled within 7 days of reservation
- Daily: \$90.00
- Weekend: \$180.00 (Friday pick-up to Monday drop-off)
- Holiday Weekend: \$225.00 (if we are closed for a holiday: Fri-Tues or Thurs-Mon)
- Weekly: \$440.00 (7 days, Friday to Friday, Thursday to Thursday, Etc.)

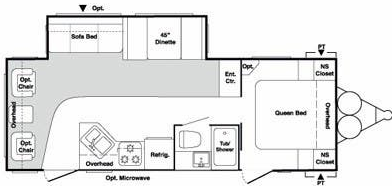

## Pioneer 29 ft.

Fully-enclosed, hard shell travel trailer

**Features:** Sleeps 8, 4-burner stove, 12 gallon water tank, sink with pump, propane tank (we do not fill the propane), and 1.9 cubic ft. refrigerator 12-110-Gas, porch lights, 2" bike receiver.

**Towing information:** Requires a class 2 hitch (no bumper hitches), weighs 6000 pounds (unloaded), ball size 2 5/16 inches.

**Additional Information:** Overall length 29', height 8', width 7'

### Prices:

- Security Deposit: \$100.00, due at reservation, non-refundable if canceled within 7 days of reservation
- Daily: \$100.00
- Weekend: \$200.00 (Friday pick-up to Monday drop-off)
- Holiday Weekend: \$250.00 (if we are closed for a holiday: Fri-Tues or Thurs-Mon)
- Weekly: \$950.00 (7 days, Friday to Friday, Thursday to Thursday, Etc.)

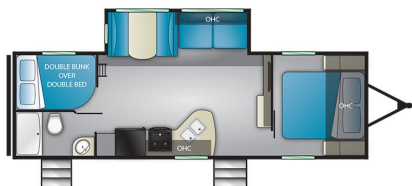

# TOWABLE CAMPER TRAILERS

## Small, Medium and Large Starcraft Popup 14 ft.

Fully-enclosed, travel trailer

**Features:** Small sleeps four (4), medium sleeps six (6), large sleeps seven (7)

**Towing information:** Requires a class 2 hitch, weighs 2090 pounds (unloaded), ball size 2 inches, 7 round electrical plug (no adapters)

**Additional Information:** Overall length 14', height 6' 5", width 7'

### Prices

- Security Deposit: \$40.00, due at reservation, non-refundable if canceled within 7 days of reservation
- Daily: \$40.00
- Weekend: \$80.00 (Friday pick-up to Monday drop-off)
- Holiday Weekend: \$100.00 (if we are closed for a holiday: Fri-Tues or Thurs-Mon)
- Weekly: \$200.00 (7 days, Friday to Friday, Thursday to Thursday, Etc.)

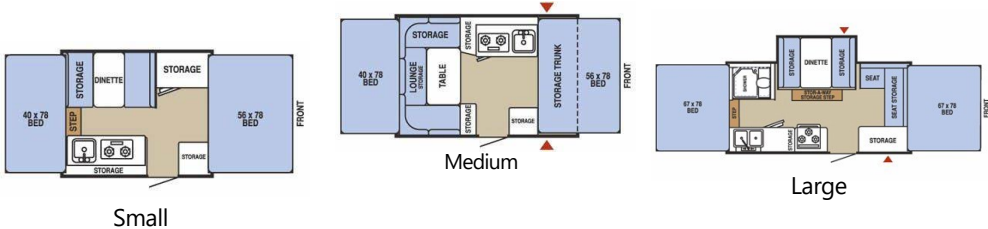

## 2009 TAB 11 ft.

Fully-enclosed, travel trailer

**Features:** Sleeps 2, 2-burner stove, kitchen, and overhead storage

**Towing Information:** Requires a class 2 hitch, weighs 1700 pounds (unloaded), ball size 2 inches, 7 round electrical plug (no adapters)

**Additional Information:** Overall length 11', height 5' 6", width 5' 8"

### Prices

- Security Deposit: \$30.00, due at reservation, non-refundable if canceled within 7 days of reservation
- Daily: \$30.00
- Weekend: \$60.00 (Friday pick-up to Monday drop-off)
- Holiday Weekend: \$75.00 (if we are closed for a holiday: Fri-Tues or Thurs-Mon)
- Weekly: \$150.00 (7 days, Friday to Friday, Thursday to Thursday, Etc.)

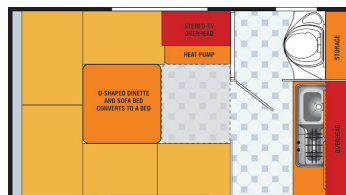

# TOWABLE TRAILERS

## 7x12 Trailer

## 5x8 Fully Enclosed

**Towing information:** Requires a class 2 hitch., ball size 2 inches, 7 round electrical plug

**Prices:**

- Security Deposit: \$20.00, due at reservation, non-refundable if canceled within 7 days of reservation
- Daily: \$20.00
- Weekend: \$40.00 (Friday pick-up to Monday drop-off)
- Holiday Weekend: \$50.00 (if we are closed for a holiday: Fri-Tues or Thurs-Mon)
- Weekly: \$100.00 (7 days, Friday to Friday, Thursday to Thursday, Etc.)

## 6x10 Trailer

Fully Enclosed

**Towing information:** Requires a class 2 hitch, ball size 2 inches, 7 round electrical plug

**Prices:**

- Security Deposit: \$25.00, due at reservation, non-refundable if canceled within 7 days of reservation
- Daily: \$25.00
- Weekend: \$50.00 (Friday pick-up to Monday drop-off)
- Holiday Weekend: \$62.50 (if we are closed for a holiday: Fri-Tues or Thurs-Mon)
- Weekly: \$125.00 (7 days, Friday to Friday, Thursday to Thursday, Etc.)

## 6x12 Trailer

Fully Enclosed

**Towing information:** Requires a class 2 hitch, ball size 2-5/16 inches, 7 round electrical plug

**Prices:**

- Security Deposit: \$35.00, due at reservation, non-refundable if canceled within 7 days of reservation
- Daily: \$35.00
- Weekend: \$70.00 (Friday pick-up to Monday drop-off)
- Holiday Weekend: \$87.50 (if we are closed for a holiday: Fri-Tues or Thurs-Mon)
- Weekly: \$175.00 (7 days, Friday to Friday, Thursday to Thursday, Etc.)

## Dump Trailer

## Car Hauler

**Towing information:** Requires a class 2 hitch, ball size 2-5/16 inches, 7 round electrical plug, 10,400 lb Max

**Prices:**

- Security Deposit: \$60.00, due at reservation, non-refundable if canceled within 7 days of reservation
- Daily: \$60.00
- Weekend: \$120.00 (Friday pick-up to Monday drop-off)
- Holiday Weekend: \$150.00 (if we are closed for a holiday: Fri-Tues or Thurs-Mon)
- Weekly: \$300.00 (7 days, Friday to Friday, Thursday to Thursday, Etc.)

## RENTAL POLICIES

10% discount for valid club members.

All equipment is available to active & Reserve military members, DoD civilians, retirees & their dependents (ages 18-22), and veterans with valid ID.

## CUSTOMER RESPONSIBILITIES

Inspect equipment prior to leaving facility & notify staff of any damage.

Damaged or lost items must be paid for upon return.

Dirty items will result in a 1 day cleaning fee. Items must be returned by the specified date.

Daily rental fees will be charged for each day there after. Equipment can be picked up

Monday - Friday 0800 - 1530

Drop off time 0800 - 1200

## RESERVATIONS:

Reservations can be made 3 months in advance with minimum 1 day fee

## CANCELLATIONS:

7 day notice is required for cancellations to avoid loss of 1 day rental fee.

## OFFICIAL FUNCTIONS:

Charcoal grill, 48 qt cooler, tables & chairs, horseshoes, softball, volleyball, and Badminton equipment are available with an equipment loan request. Form is required 7 days prior to event.

### RV STORAGE LOT

Located at Outdoor Recreation  
RV Storage is priced per month

Uncovered: \$15.00

Covered: \$45.00

- 15 days after due date there will be a \$2.00 per day late fee assessed.
- Vehicles must be road-worthy with current registration and insurance on file with ODR.

## GRISSOM SERVICES

### CHOCKS:

Friday-Saturday 1600-2200  
688-2615

### LODGING:

Mon-Fri 0600-2200  
UTA weekends open 24hrs  
688-2844

### FITNESS CENTER:

Mon-Fri 0500-1900  
UTA Weekends:  
Saturday's 0500 - 1800  
Sunday's 0500-1300  
688-2000

### BOOMERS CAFE:

Mon-Fri 1100-1300  
688-2751



## OUTDOOR RECREATION PROGRAMS & TRIPS

Outdoor Recreation has a variety of programs and trips throughout the year, such as, white water rafting, hiking, fishing, horseback riding, & tandem skydiving

## VOLUNTEER OPPORTUNITIES

Volunteer opportunities are available, please contact outdoor recreation at 688-2000 for more information.



Find us on Facebook!  
**GRISSOMSERVICES**